

**Step 1: Changing the Sub-Plate (Conversion Kit #095207)**

**With this new EZJect System, you must use the NEW Shell Plates with the groove cut in the bottom. Please refer to Fig. 1 for more details.**

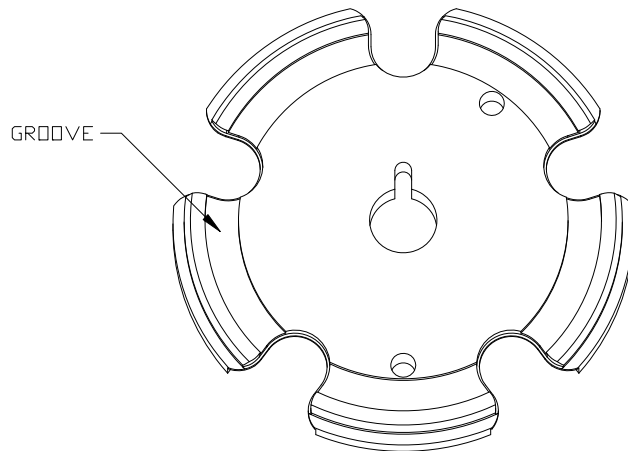

**Figure 1: Shell Plate with Groove**

- Raise the Eject Wire (#46) to move it out of the way, or remove the Eject Wire (#46) by loosening the Screw underneath the Sub-Plate.
- Use a 9/16" end wrench to remove the bolt holding down the shell plate and remove the shell plate.
- Remove the case retainer spring.
- Remove the primer feed assembly.
- Unhook the extension spring from the primer slide and remove it from the Sub-Plate (#44).
- Remove the primer slide from the Sub-Plate.

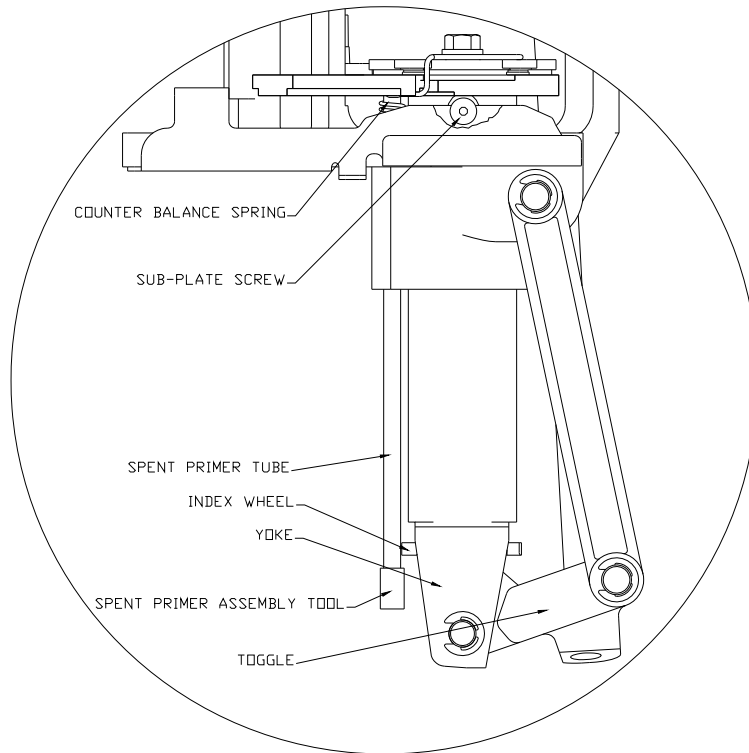

**Figure 2: Spent primer tubes dismantle / assembly.**

- Place the spent primer assembly tool in the bottom of the spent primer tube. Take a pair of pliers or vise grips and clamp onto the spent primer tube approximately ¼” from the end and *tap* the pliers with a hammer to remove the spent primer tube. Be careful not to lose the Counter Balance spring.

**See Figure 2 for more details.**

- Raise the ram to the top of the stroke and “Block” it into place.
- The Ram can be blocked into place by inserting the handle of a medium sized screw driver between the “Toggle” and the “Yoke” near the pawls. Be careful not to put extreme pressure on the Index wheel as you may damage it.
- Use a 5/32” Allen wrench to remove the two screws that secure the Sub-Plate onto the ram. If the screws are really tight take a Hammer and tap on the end of the Allen Wrench to break the screws loose.
- Remove the “Block” and lower the ram and remove the “Sub-Plate”.
- Install the new “Sub-Plate”, raise the ram and replace the “Block” before installing the screws and tightening them very tight. (Be careful not to strip the socket or damage the threads.)
- Once again, remove the “Block”, lower the ram and replace all parts in the reverse order that you removed them.